

Courses & Distances  
Down Juniata river

- 1 N 32 E 29
- 2 N 45 E 28
- 3 N 68 1/2 E 5 1/4

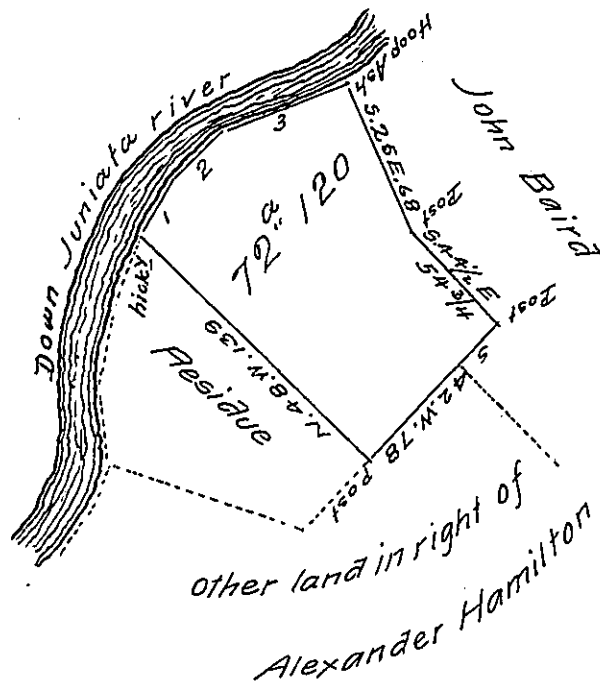

*Draft of Seventy two acres and One hundred and twenty perches of land with six per Cent for roads. Situate in Wayne Township in Mifflin County, which is part of a tract of land surveyed 5<sup>th</sup> July 1769 warrant to Alexander Hamilton dated 10<sup>th</sup> February 1755 said to contain 104<sup>2</sup>/<sub>5</sub> acres but found to contain upon resurvey of the original lines 118<sup>a</sup> & 14.4 perches. Resurveyed the above part agreeably to the original lines on the ground 10<sup>th</sup> July 1817*

*Michael M Monahan*

*To Richard T. Leech Esquire*

*Surveyor General of Pennsylvania*

IN TESTIMONY that the above is a copy of the original remaining on file in the Department of Internal Affairs of Pennsylvania, made conformably to an Act of Assembly approved the 16th day of February 1833, I have hereunto set my hand and caused the Seal of said Department to be affixed at Harrisburg, this thirteenth day of November 1907

*Henry Howell*  
Secretary of Internal Affairs.